

**signatory**  
**STEVENAGE BOROUGH COUNCIL**

ROAD TRAFFIC REGULATION ACT 1984

**THE BOROUGH OF STEVENAGE (NEIGHBOURHOOD CENTRES, STEVENAGE) (OFF STREET PARKING PLACES) ORDER 2024**

Stevenage Borough Council, pursuant to the arrangements made under Section 19 of the Local Government Act 2000 with Hertfordshire County Council in exercise of their powers under Sections 32, 33, 34, 35 and 35A-C of the Road Traffic Regulation Act 1984, (which said Act of 1984 is hereinafter referred to as "the Act of 1984") and Part IV of Schedule 9 of the Act of 1984' and of all other enabling powers and after consultation with the Chief Officer of Police in accordance with Part III of Schedule 9 of the Act of 1984, hereby make the following Order:-

**Commencement & Citation**

1. This Order may be cited as "The Borough of Stevenage (Neighbourhood Centres, Stevenage) (Off Street Parking Places) Order 2024" and shall come into operation on 6 May 2024.
2. The Borough of Stevenage (Neighbourhood Centres, Stevenage) (Off-Street Parking Places) Order 2024 plans (hereinafter referred as "off street plans") listed in Schedule 1 of this Order and identified as TPE/03/23-7/01, TPE/03/23-7/02, TPE/03/23-7/03, TPE/03/23-7/04, TPE/03/23-7/05, TPE/03/23-7/06, TPE/03/23-7/07, inclusive of their keys are incorporated into this Order.

**Interpretation**

3.
  - 1) Save as otherwise defined within this Order each and every expression shall have the meaning assigned to it by the Traffic Signs Regulations and General Directions 2016.
  - 2) In this Order, except where the context otherwise requires, the following expressions have the meaning hereby respectively assigned to them:

"Access Way" means a way that enables ingress to or egress from a Parking Bay or Parking Place.

"Act of 1984" means the Road Traffic Regulation Act 1984;

"bay markings" means any lines marked on the surface of a parking place to indicate the limits of each individual parking bay;

"Car Park" means an area of land that is designated as a Parking Place by this Order.

"Approved method of payment" means payment by credit, debit, pre-paid or any other electronic card or any other type of payment through a scheme organised by the Council;

"Delivering" and "Collecting" in relation to any goods include checking the goods for the purpose of their delivery or collection;

"Council" means Stevenage Borough Council and includes any parking service contractors or authorised agent appointed by and acting on behalf of the Council for the purposes of any function under the provisions of this Order and as defined by the Traffic Management Act 2004.

“Charging Device” means an installation in or adjacent to a parking place for the purposes of recharging the batteries of an electric vehicle or hybrid vehicle by means of a connecting lead.

“Civil Enforcement Officer” has the same meaning as defined in the Traffic Management Act 2004, as appointed by or on behalf of Stevenage Borough Council.

“Designated Officer” means an Officer nominated by the Council to carry out Council Functions under the provisions of this Order.

“Disabled Parking Bay” means a Parking Bay identified by a sign or a marking within or adjacent to a Parking Bay as for the use of Disabled Persons’ Vehicles.

“Disabled Person” means a disabled person of a description prescribed by Regulation 4 of the Disabled Persons (Badge for Motor Vehicles) (England) Regulations 2000 SI 682.

“Disabled Persons Badge” and “Parking Disc” have the same meaning as given in the Disabled Persons (Badges for Motor Vehicles) (England) Regulations 2000 SI 682.

“Disabled Person’s Vehicle” means a vehicle lawfully displaying a Disabled Person’s Badge in the relevant position and which is a vehicle which, immediately before or after any period of waiting allowed by virtue of a provision of a kind required by Regulation 8 of the Local Authorities’ Traffic Orders (Exemptions for Disabled Persons) (England) Regulations 2000 SI 683, has been or is to be driven by a Disabled Person or, as the case may be, has been or is to be used for carrying a Disabled Person or Persons as passengers.

“Driver” means the person driving or having control or charge of the Vehicle at any given time and in particular in relation to the Vehicle waiting in a Parking Bay or Parking Place the person driving at the time it was left in that Parking Place.

"Electric Vehicle" means a vehicle which uses electricity as a source of power for propulsion which is derived from an electric storage battery which is not connected by an exterior charging lead to any power source whilst the vehicle is in motion and includes a vehicle which in addition uses, or is capable of using, other sources of power for propulsion;

"Electric Vehicle Charging Bay" means an area contained within a Parking Place delineated by painted road markings to indicate the marked limits of the bay and the position in which an Electric Vehicle may be parked and as identified in the key and shown in “the off street plans” and identified in the keys to those plans;

"Key" means the Key attached to “the off street plans” to be read in conjunction with those plans;

“Enactment” means any enactment, whether public general or Local and includes any Order, Byelaw, Rule, Regulation, Scheme or other instrument having effect by virtue of an enactment.

“Goods” means goods of any kind whether animate or inanimate and includes postal packets of any description; “delivering” and “collecting” in relation to goods includes checking the goods for the purpose of their delivery or collection.

“Goods Vehicle” means a motor vehicle that is constructed or adapted for use for the carriage of goods or burden of any description.

“Hand-held Device” means a wireless hand-held computer which is programmed to interface with the Telephone Payment System.

“Hybrid Vehicle” means an electric vehicle which has at least one other energy source for traction purposes.

“Loading Area” means an area contained within a Parking Place which is designated to be used solely for the use of loading or unloading a vehicle and is indicated as such by suitable signs within and/or by suitable markings on the surface of the Parking Place.

“Motorcycle” has the meaning as in Section 185(1) of the Road Traffic Act 1988.

“Motorcycle Parking Bay” means a Parking Bay identified by a sign or a marking within or adjacent to a Parking Bay as for the use of motorcycles only.

“Owner” in relation to a Vehicle means the person by whom such a vehicle is kept and or used.

“Motor Vehicle” has the meaning as given by Section 136(1) of the Act of 1984;

“Parking Bay” means an area contained within a Parking Place in which is designated for the leaving of one vehicle at a time, unless specifically provided for more than one vehicle, which is indicated by suitable markings on the surface of the Parking Place to show the extents of that individual Parking Bay.

“Parking Place” means an area of land, including any Access Way, that is provided by the Council under Section 32 of the Act of 1984 for use as an off-street parking place, as designated by Article 3 of and the Schedule to this Order.

“Passenger Vehicle” means a motor vehicle constructed solely for the carriage of passengers and their effects and adapted to carry not more than twelve passengers exclusive of the Driver and not drawing a trailer.

“penalty charge” shall have the same meaning as a charge set by the Council in accordance with The Civil Enforcement of Road Traffic Contraventions (Approved Devices, Charging Guidelines and General Provisions) (England) Regulations 2022 and the provisions of Part 6 and Schedule 9 of The Traffic Management Act 2004;

“penalty charge notice” shall mean a notice issued by a Civil Enforcement Officer in accordance with The Civil Enforcement of Road Traffic Contraventions (Approved Devices, Charging Guidelines and General Provisions) (England) Regulations 2022 and the provisions of Part 6 and Schedule 9 of The Traffic Management Act 2004;

“The Regulations of 2022” means ‘The Civil Enforcement of Road Traffic Contraventions (Approved Devices, Charging Guidelines and General Provisions) (England) Regulations 2022’;

“Permitted Hours” means the hours and days of the week specified in the Schedule to this Order.

“Relevant Position” in relation to a Disabled Persons Badge means on the dashboard or fascia of the vehicle or where the vehicle is not fitted with a dashboard or fascia in a conspicuous position on the nearside of the vehicle or if the vehicle is being used by a disabled person, in such a position as described in the Disabled Persons (Badges for motor vehicles) (Amendments) Regulations 2000 SI 682 and in all cases displayed in such a position as to be clearly visible from outside the vehicles front or nearside.

“Restricted Waiting Area” means any part of a Parking Place that is not a Parking Bay or Loading Area.

“Vehicle” means motor vehicle and “motor vehicle” has the same meaning as in section 136 of the Act of 1984.

“Road” means any length of highway or of any other road to which the public has access, and includes bridges over which a road passes as set out in s142 (1) of the 1984 Act;

“Traffic Sign” means a device or object as prescribed or authorised under, or having effect as though prescribed or authorised under Section 64 of the Act of 1984;

“Telecommunication system” has the meaning as in the Telecommunications Act 1984 (c.12)

“Universal Service Provider”, “Provision of a universal Postal Service” and “Postal Packet” shall bear the same meaning as in the Postal Services Act 2011.

“the off street plans” means The Borough of Stevenage (Neighbourhood Centres, Stevenage) (Off Street Parking Places) Order 2023 Plans including their keys, and listed in Schedule 1 of this Order which are incorporated into this Order pursuant to Article 2 hereof;

- 3) Any reference in this Order to a numbered Article or Schedule shall unless the context otherwise requires, be construed as a reference to the Article or Schedule bearing that number in this Order.
- 4) Any reference in this Order to any enactment shall be construed as a reference to that enactment as amended, applied, consolidated, re-enacted by or having effect by virtue of any subsequent enactment.
- 5) The Interpretation Act 1978 shall apply for the interpretation of this Order as it applies for the interpretation of an Act of Parliament.
- 6) The provisions of the following Order are hereby revoked only in so far as they are affected by the restrictions imposed by this Order:  
“The Borough of Stevenage (Various Road, Stevenage) (Disabled Persons Parking Places) Order 2020”.
- 7) The restrictions imposed by this Order shall be in addition to and not in derogation from any restriction or requirement imposed by any other regulations made or having effects as if made under the Act of 1984 or by or under any other enactment.

## **Provisions of the Order**

### **Designation of parking places**

#### **4.**

- 1) Each area as shown on the Off-Street Plans and indicated in the keys to those plans as a parking place is authorized as a parking place and may be used subject to the conditions and restrictions imposed by this Order for the parking of motor vehicles.
- 2) Subject to the provisions of this order, parking places may be used for the leaving at any time only of vehicles of the following classes:

- (a) passenger vehicles the overall height of which does not exceed 2.3 metres and the overall length of which does not exceed 5.25 metres;
  - (b) goods carrying vehicles the overall height of which does not exceed 2.3 metres and the overall length of which does not exceed 5.25 metres;
  - (c) motorcycles; and
  - (d) disabled persons vehicles.
- 3) Each area within a Parking Place and marked out for the purpose of parking in accordance with the provisions of this Order and not comprised within a Restricted Waiting area or Loading Area is hereby designated as a Parking Bay.

#### Parts of a parking place in which vehicles may not be left

**5.**

- 1) No person shall cause or permit any vehicle to wait in an area designated as a Parking Place or Parking Bay during permitted hours unless authorised by the subsequent provision of this Order or with the permission of a designated Constable or Civil Enforcement Officer or duly authorised Officer of the Council.
- 2) No person shall cause or permit any vehicle to be left in an area designated as a Parking Place unless it is entirely within the confines of a marked Parking Bay.

#### Conditions and restrictions on the use of a Parking Place

6. No person shall cause or permit any vehicle to enter or be left in the Parking Place or part thereof unless the vehicle is of a class specified in Article 4.
7. No person shall cause or permit any vehicle to be left in a Disabled Parking Bay other than a Disabled Person's Vehicle displaying in the Relevant Position a Disabled Person's Badge.
8. No person shall cause or permit any vehicle to be left in a Motorcycle Parking Bay other than a motorcycle.
9. No person shall cause or permit any vehicle to be left in an Electric Vehicle Parking Bay other than an electric or hybrid vehicle that it is connected to a Charging Device by means of a connecting lead for the purpose of recharging the batteries of the said vehicle and actively recharging via the connecting lead.
10. Where a sign or a marking within the Parking Place indicates that part of that Parking Place is designated for loading and unloading no person shall cause or permit any vehicle to wait or be left in that Loading Area other than for the purpose of loading or unloading goods.
11. No person shall cause or permit any vehicle to wait or be left at any time, including waiting for the purposes of loading or unloading the vehicle, in such a way that the vehicle causes an obstruction to the ingress or egress of vehicles on an Access Way or to the lawful use of the Parking Place.
12. Where in the parking place signs or markings indicate the direction in which or maximum speed at which a vehicle shall proceed no person shall cause or permit any vehicle to proceed in the parking place other than in the direction or below the maximum speed indicated as the case may be.
13.
  - 1) No person shall use any parking place at any time or any vehicle while it is in a parking place in connection with the sale or offering or exposing for sale of any goods to any person in or near the parking place or in connection with the selling of offering for sale of his skill in handicraft or his services in any other capacity.
  - 2) Provided that nothing in this Article shall prevent the sale of goods from a vehicle:
    - (a) if the vehicle is a passenger vehicle, a goods carrying vehicle, a motorcycle, or an invalid carriage and the goods are immediately delivered

- at or taken into premises adjacent to the vehicle from which the sale is effected; or
- (b) if the vehicle is one to which the provisions of Article 13(1)(i) apply.

#### Exceptions from restrictions on waiting by a vehicle in a parking place

#### 14.

- 1) Notwithstanding the foregoing provisions of this Order any vehicle may wait in any part of a parking place if the use of that part has not been suspended and if:
- (a) the vehicle is waiting for so long as may be necessary for the purpose of enabling any person to board or alight from the vehicle or load thereon or unload therefrom their personal luggage; or
  - (b) the vehicle is waiting owing to the driver being prevented from proceeding by circumstances beyond their control or to such waiting being necessary in order to avoid an accident; or
  - (c) the vehicle is being used for fire brigade, ambulance or police purposes; or
  - (d) the vehicle, not being a passenger vehicle, is being used in the service of a local authority in pursuance of statutory powers or duties provided that in all the circumstances it is reasonably necessary in the exercise of such powers or in the performance of such duties for the vehicle to wait in the place in which it is waiting; or
  - (e) the vehicle is waiting for so long as may be necessary to enable it to be used in connection with the removal of any obstruction to traffic; or
  - (f) the vehicle is waiting:
    - i. while postal packets addressed to premises adjacent to the parking place in which the vehicle is waiting are being unloaded from the vehicle or, having been unloaded there from, are being delivered; or
    - ii. while postal packets are being collected for the loading on the vehicle from premises or posting boxes adjacent to the parking place in which the vehicle is waiting or, having been so collected, are being loaded thereon; or
  - (g) the vehicle, not being a passenger vehicle, is waiting only for as long as may be reasonably necessary to enable it to be used for the purpose specified in Article 11(1)(b); or
  - (h) the vehicle is in actual use in connection with the removal of furniture to or from one office to a dwelling-house adjacent to the parking place from or to a depository, another office or dwelling-house; or
  - (i) in any other case the vehicle is waiting for the purpose of delivering or collecting goods or loading or unloading the vehicle at premises adjacent to the parking place in which the vehicle is waiting and the vehicle does not wait for a period exceeding twenty minutes or for such longer period as a police constable in uniform, a designated officer or Civil Enforcement Officer may approve.
- 2) Except as provided by this Order, the driver or person in charge of a vehicle shall not cause or permit a vehicle to wait in a parking place at any time.
- 3) Nothing in the provisions of this Order shall be taken as authorising anything which would be a contravention of any regulations made or having effect as if made under Section 25 of the Road Traffic Regulation Act 1984.

#### Alteration of a position of a vehicle in a Parking Place

15. Where any vehicle is standing in a parking place in contravention of the provisions of this Order, a Civil Enforcement Officer may cause to be altered the position of the vehicle in order that its position shall comply with those provisions.

#### Removal of a vehicle from a Parking Place

16. Where a Civil Enforcement Officer is of the opinion that any of the provisions contained in this Order have been contravened or not complied with in respect of a vehicle left in any part of a parking place; or restricted waiting area they may remove or cause to be removed the vehicle from the parking place or restricted area and, where it is so removed, shall provide for the safe custody of the vehicle and its contents.

#### Movement of a vehicle in a parking place in an emergency

17. A police Constable in uniform or a Civil Enforcement Officer may cause to be moved, in case of emergency, to any place he thinks fit any vehicle left in a parking place.

#### Power to suspend the use of a parking place

18.

- 1) Any person authorised by the Council or a police constable in uniform may suspend the use of a Parking Place or any part thereof whenever they consider such a suspension reasonably necessary:
  - (j) for the purposes of facilitating the movement of traffic or promoting its safety; or
  - (k) for the purposes of any building operation, demolition or excavation in or adjacent to the Parking Place or the maintenance, improvement or of the parking place or the laying, erection, alteration, removal or repair in or adjacent to the parking place of any sewer or of any main, pipe or apparatus for the supply of gas, water or electricity or of any telecommunications apparatus or traffic sign; or
  - (l) for the convenience of occupiers of premises adjacent to the parking place on any occasion for the removal of furniture from one office or dwelling house to another place; or
  - (m) on any occasion on which it is likely by reason of some special attraction that any street will be thronged or obstructed; or
  - (n) for the convenience of occupiers of premises adjacent to the parking place at times of weddings or funerals or on other special occasions; or
  - (o) for the purposes of facilitating the cleansing of the parking place.
- 2) Any person suspending the use of a parking place or any part thereof in accordance with the provisions of paragraph 1) of this Article shall thereupon place or cause to be placed in or adjacent to that parking place or part thereof a traffic sign indicating that waiting by vehicles is prohibited.
- 3) No person shall cause or permit a vehicle to wait in a parking place or any part thereof during the period indicated by a traffic sign placed in pursuance of paragraph 2) above provided that nothing in this paragraph shall apply:
  - (p) to any vehicle being used for fire brigade, ambulance or police purposes; or
  - (q) any vehicle which is waiting for the reason the bay was suspended; or
  - (r) to anything done with permission of the person suspending the use of the parking place or part thereof in pursuance of paragraph (1) of this Article; or
  - (s) if the vehicle is waiting owing to the driver being prevented from proceeding by circumstances beyond their control or to such waiting being necessary in order to avoid an accident.

### Payment to recoup electricity costs

- 19.** Where a Charging Device is provided within a Parking Place, the Charging Device may apply a monetary fee for the use of electricity at any time. This is not and shall not be considered a fee for parking and may be set and varied by the Council or such other body as may operate the Charging Device from time to time, subject to such caps and limits as may be set by primary and secondary legislation.

### Maximum period a vehicle may be left in a parking place

- 20.**
- 1) Where a traffic sign indicates that a maximum period of stay applies to a parking bay within the parking place or part of the parking place, no vehicle shall be left in that parking bay within the parking place or part of the parking place for longer than the maximum period of stay indicated on that traffic sign.
  - 2) Provided that nothing in this Article shall apply to a Disabled Persons Vehicle when a Disabled Persons Badge is displayed in the relevant position.

### Interval before a vehicle may again be left in a parking place

- 21.** Where a traffic sign indicates that a period of no return applies to a parking bay within the parking place or part of the parking place, no vehicle which has left that parking bay within the parking place or that part of the parking place shall return to any parking bay within the parking place or part of the parking place that is indicated by a similar traffic sign to be subject to a period of no return within the period of no return indicated on that traffic sign.

### Penalty Charges

- 22.**
- 1) If a vehicle (other than a vehicle otherwise exempted by this Order) is left at any time in contravention of any provision of this Order a penalty charge shall be payable.
  - 2) In the case of a vehicle in respect of which a penalty charge is payable, a penalty charge notice may be issued by a Civil Enforcement Officer in uniform in accordance with The Civil Enforcement of Road Traffic Contraventions (Approved Devices, Charging Guidelines and General Provisions) (England) Regulations 2022.
- 23.** The penalty charge shall be paid to Stevenage Borough Council in accordance with the instructions and within the time limits specified on the penalty charge notice.
- 24.** The period for which a vehicle may be left in a parking place during the permitted hours after the penalty charge has been incurred shall not exceed one hour.
- 25.**
- 1) Where a penalty charge notice has been attached to a vehicle in accordance with the provisions of this Order, no person, not being the driver of the vehicle, shall remove the notice from the vehicle unless authorised to do so by the driver of the vehicle.
  - 2) Provided that nothing in this Article shall apply to a Civil Enforcement Officer or police constable in uniform or a person removing the vehicle in pursuance of an arrangement made by the police constable in uniform or under the regulations in pursuance of powers contained in sections 99, 100, 101, and 102 of the Act of 1984.

### Other provisions



- 26.** Vehicles are parked at the owner's risk and the Council shall not be liable for any damage to or theft of a vehicle or its contents while the vehicle is left within the car park.
- 27.** The driver of a vehicle shall not permit that vehicle to wait in a parking place unless the vehicle is licensed in pursuance of the provisions of the vehicle (Excise) Act 1971 and unless there is in relation to the use of the vehicle by the driver such a policy of insurance as complies with the requirements of Part VI of the Road Traffic Act 1972.
- 28.** A driver shall always while their vehicle is in a parking place comply with any reasonable instruction given by a person authorised in that behalf by the Council.
- 29.** Where in a parking place signs are erected or surface markings are laid for the purpose of:-
- (a) indicating the entrance to or exit from the parking place, or
  - (b) indicating that a vehicle using the parking place shall proceed in a specified direction within the parking place,
- no person shall drive or permit to be driven any vehicle unless with the permission of a person authorised by the Council (i) so that it enters the parking place otherwise than by an entrance, or leaves the parking place otherwise than by an exit, so indicated, or (ii) in a direction other than so specified.
- 30.** No person shall, except with the permission of a person authorised by the Council in that behalf, drive or permit to be driven any vehicle in a parking place for any purpose other than for the purpose of leaving that vehicle in the parking place in accordance with the provisions of this Order and for the purposes of departing from the parking place.
- 31.** The driver of a vehicle using a parking place is not permitted to drive any vehicle without due care and consideration or in a manner likely to endanger any other person.
- 32.** No person shall drive or ride (otherwise than in a side car) on a motorcycle in a parking place without wearing protective headgear within the meaning of the Motor Cycles (Protective Helmets) Regulations 1980 PROVIDED that this Article shall not apply to any person driving or riding on a motorcycle in any of the circumstances mentioned in Regulation 4(2) of those Regulations.
- 33.** Any person using a parking place as a means of passage proceeding from one road to another road or for access purposes to property or land adjacent to but not forming any part of the parking place shall be deemed to be so using by licence of the Council and not as of right.
- 34.** If at any time in or on a parking place or places or in any position adjacent thereto a particular space or spaces is or are reserved by means of a sign or surface marking for the use of any person or category of persons authorised by the Council or for the leaving of motorcycles, no person shall leave a vehicle in any such parking space other than for the purpose specified.
- 35.** The Council does not undertake to supervise the parking places shown on plans listed in Schedule 1 to this Order and entry to and exit from and use of these parking places is entirely at the users risk and although the Council, its servants or agents do not attempt to exempt themselves from their common law duty of reasonable skill and care or their obligations under the Occupiers Liability Acts 1957 and 1984 the Council, its servants and agents do not accept liability for any damage to or loss of vehicles or their contents which arise from acts or omissions outside their reasonable control.

36. A driver of a vehicle shall not use a parking place so as unreasonably to prevent access to any premises adjoining the parking place or so as to be a nuisance to the Council or the owners or occupiers of any adjoining property or to any person using the parking place.
37. No person shall in a parking place light or cause to permit to be lit any fire.
38. No person shall deposit in a parking place any vehicles, goods equipment, matter or materials so as to obstruct any part of a parking place without the prior written consent of the Council.
39. No person shall remove, damage or in any way interfere with any barrier or machinery whether moveable or immovable, or any sign or equipment in a parking place unless so authorised by a person authorised in that behalf by the Council.
40. No person shall wilfully, carelessly or negligently deface, injure, damage or destroy any part of a parking place or any wall, fence or marking, sign, fitting or equipment in or on a parking place.
41. A driver shall not abandon a vehicle in a parking place.
42. If it appears to the Council that a vehicle has been abandoned, the Council may sell or otherwise dispose of the vehicle provided the power of disposal conferred by this Article shall not be exercisable unless there have been taken by the Council such of the relevant steps as are required to be taken by it in exercising its powers to remove abandoned vehicles contained in the Refuse Disposal (Amenity) Act 1974.
43. Any person using a parking place shall not cause or suffer any dog belonging to him or in his charge to enter or remain in a parking place unless such dog be and continues to be on a lead and under proper control and effectively restricted from causing annoyance to any person and from worrying or disturbing any animal or is effectively confined within the vehicle.
44. The restrictions imposed by this Order shall be in addition to and not in derogation from any restriction or requirement imposed by any other regulations made or having effect as if made under the Act of 1984 or by or under any other enactment.

**Schedule 1: The Borough of Stevenage (Neighbourhood Centres, Stevenage) (Off Street Parking Places) Order Plans 2024**

Plan number	TPE/03/23-7/01
Plan number	TPE/03/23-7/02
Plan number	TPE/03/23-7/03
Plan number	TPE/03/23-7/04
Plan number	TPE/03/23-7/05
Plan number	TPE/03/23-7/06
Plan number	TPE/03/23-7/07

**Schedule 2: Parking Places**

Item number	Name of Parking Place	Description	Permitted hours
1	Filey Close (Rear) Car Park	That area edged red in the attached plan, plan number TPE/03/23-7/01	At all times
2	Bedwell	That area edged red in the	At all times

Item number	Name of Parking Place	Description	Permitted hours
	Shops Car Park	attached plan, plan number TPE/03/23-7/02	
3	Archer Road Shops Car Park	That area edged red in the attached plan, plan number TPE/03/23-7/03	At all times
4	St Nicholas Pavilion Car Park	That area edged red in the attached plan, plan number TPE/03/23-7/04	At all times
5	The Hyde Shops Car Park	That area edged red in the attached plan, plan number TPE/03/23-7/05	At all times
6	The Glebe Shops (Rear) Car Park	That area edged red in the attached plan, plan number TPE/03/23-7/06	At all times
7	Oaks Cross Shops Car Park	That area edged red in the attached plan, plan number TPE/03/23-7/07	At all times

IN WITNESS whereof the Common Seal of Stevenage Borough Council was hereunto affixed this 7 day of March 2024.

The Common Seal of )  
Stevenage Borough Council )  
was hereunto affixed )  
in the presence of:- )



*Thomas Pity*  
.....

Authorised signatory

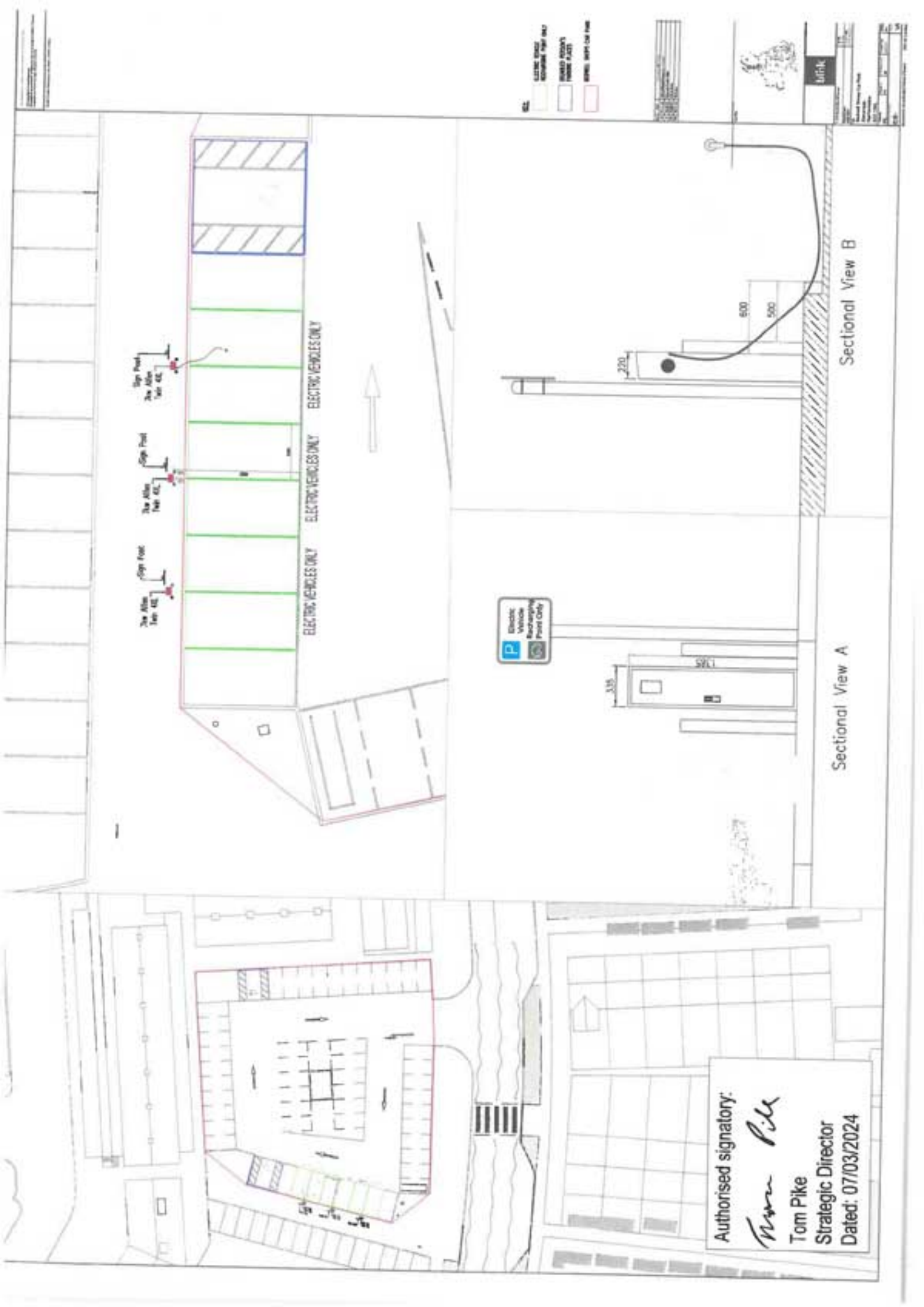

LEG  
 --- EXISTING WALL  
 --- NEW WALL  
 --- EXISTING DOOR  
 --- NEW DOOR  
 --- EXISTING WINDOW  
 --- NEW WINDOW

2x6 Allen 100V 40A  
 2x6 Allen 100V 40A  
 2x6 Allen 100V 40A  
 ELECTRIC VEHICLES ONLY  
 ELECTRIC VEHICLES ONLY  
 ELECTRIC VEHICLES ONLY



3.15

Sectional View A

2.70  
500  
500

Sectional View B

Authorised signatory:  
*Tom Pike*  
 Tom Pike  
 Strategic Director  
 Dated: 07/03/2024

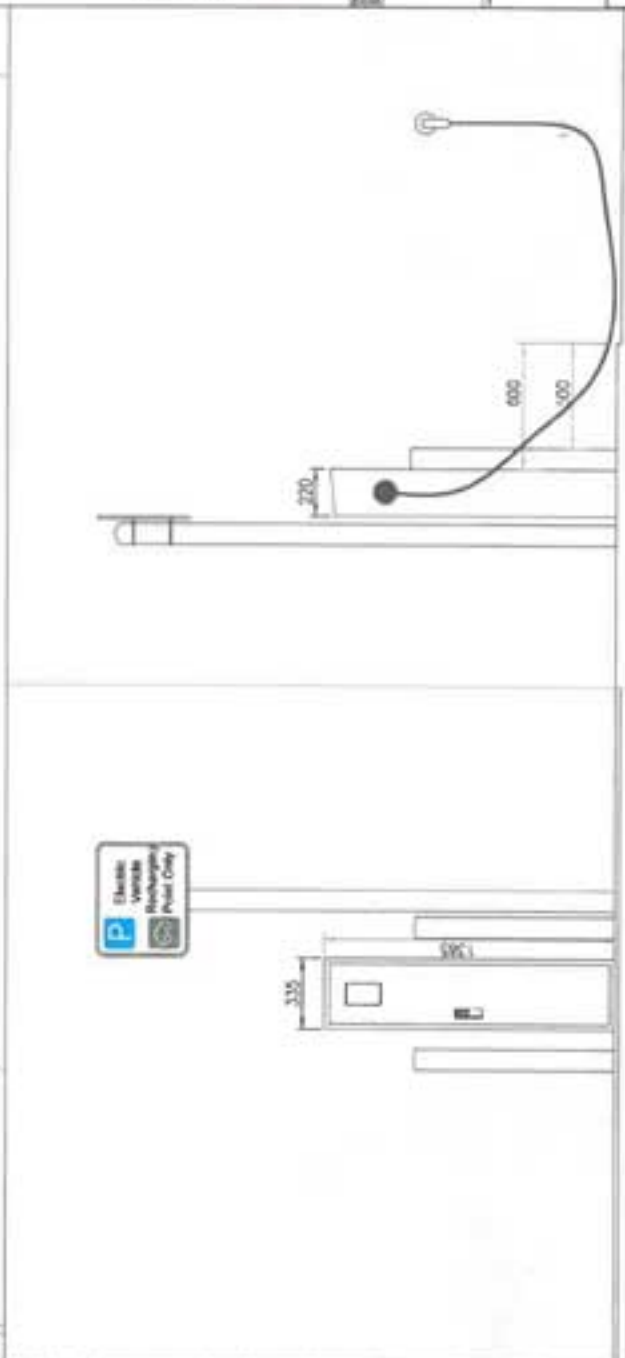
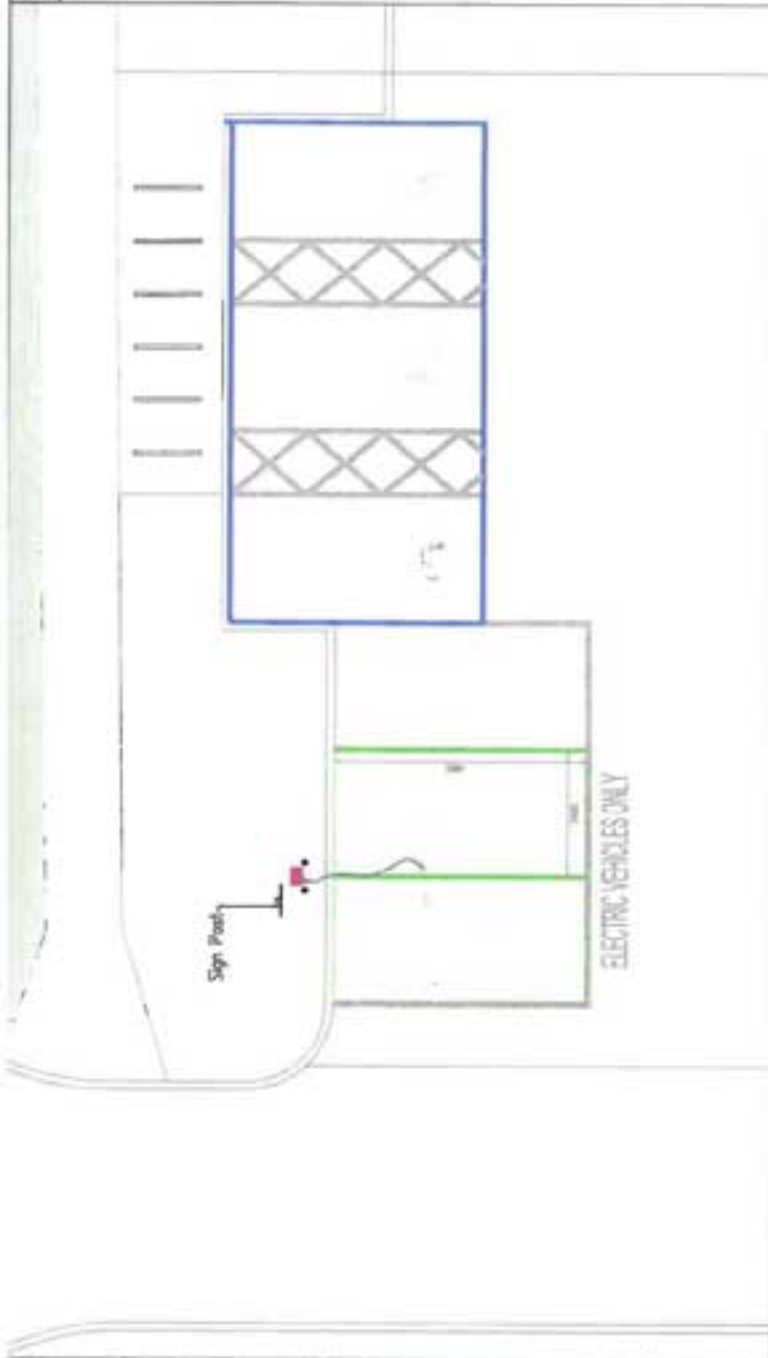

Authorised signatory:  
*Tom Pike*  
 Tom Pike  
 Strategic Director  
 Dated: 07/03/2024

- ELECTRIC VEHICLE CHARGING POINT ONLY
- GENERAL RECEIPT PARKING PLACE
- Other Use Not For Use

Authorised signatory:

*Tom Pike*

Tom Pike  
Strategic Director  
Dated: 07/03/2024

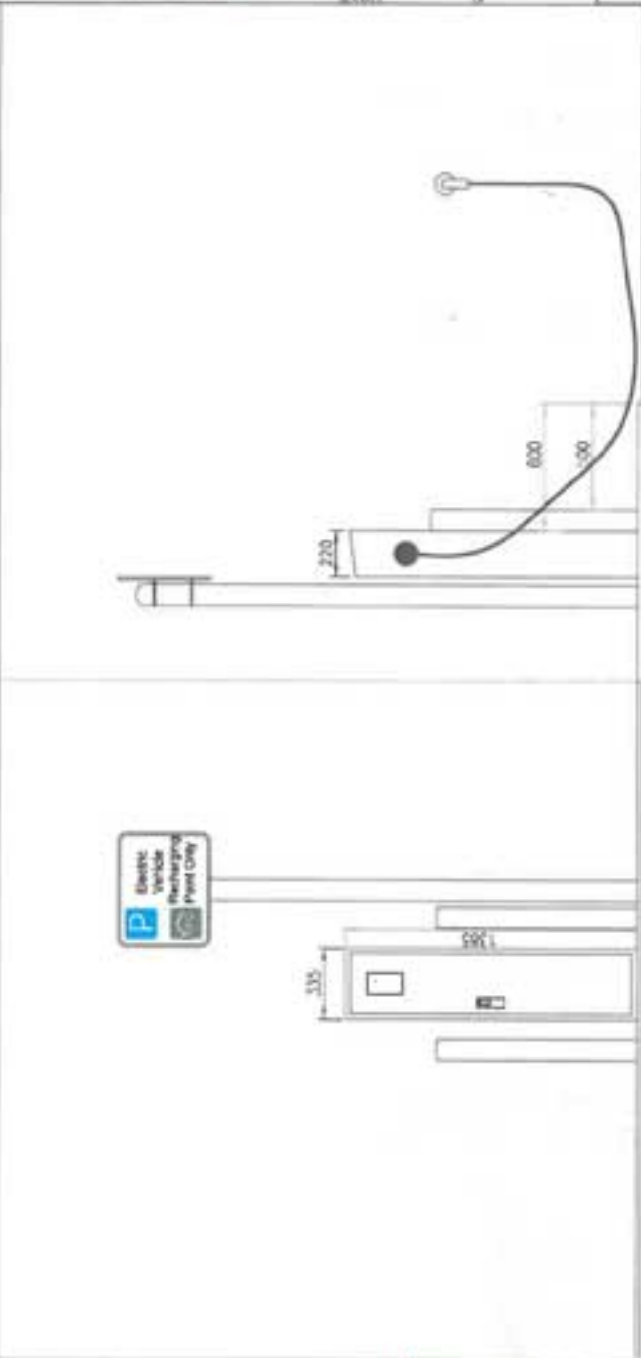
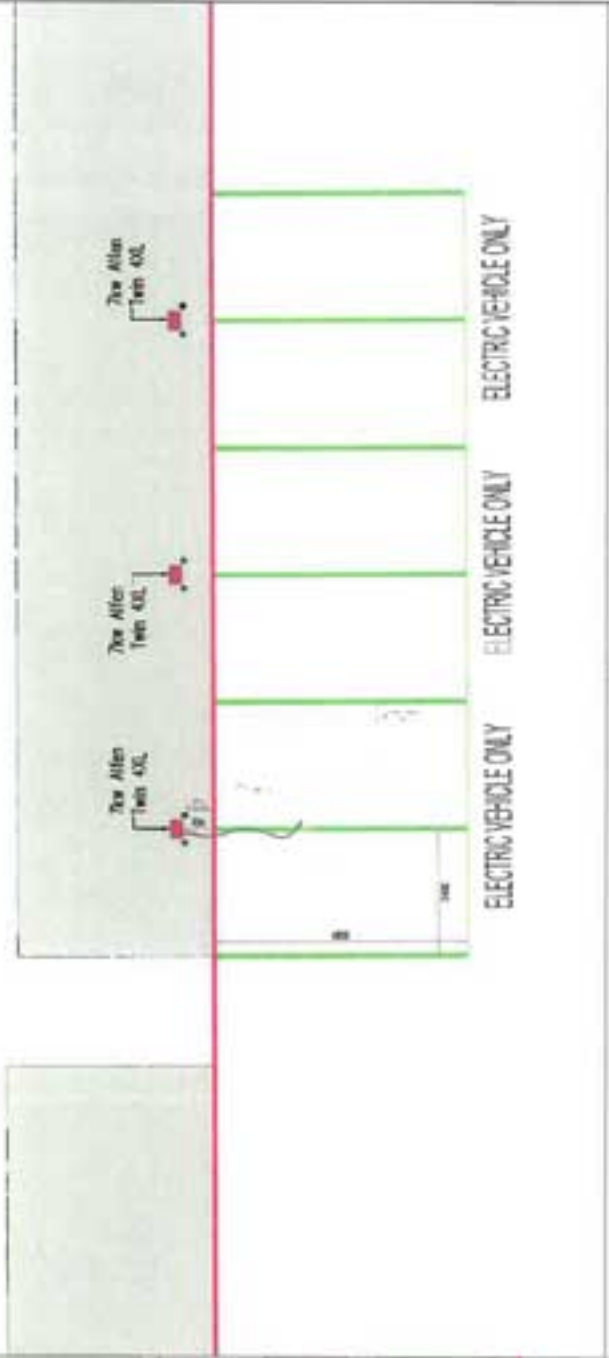
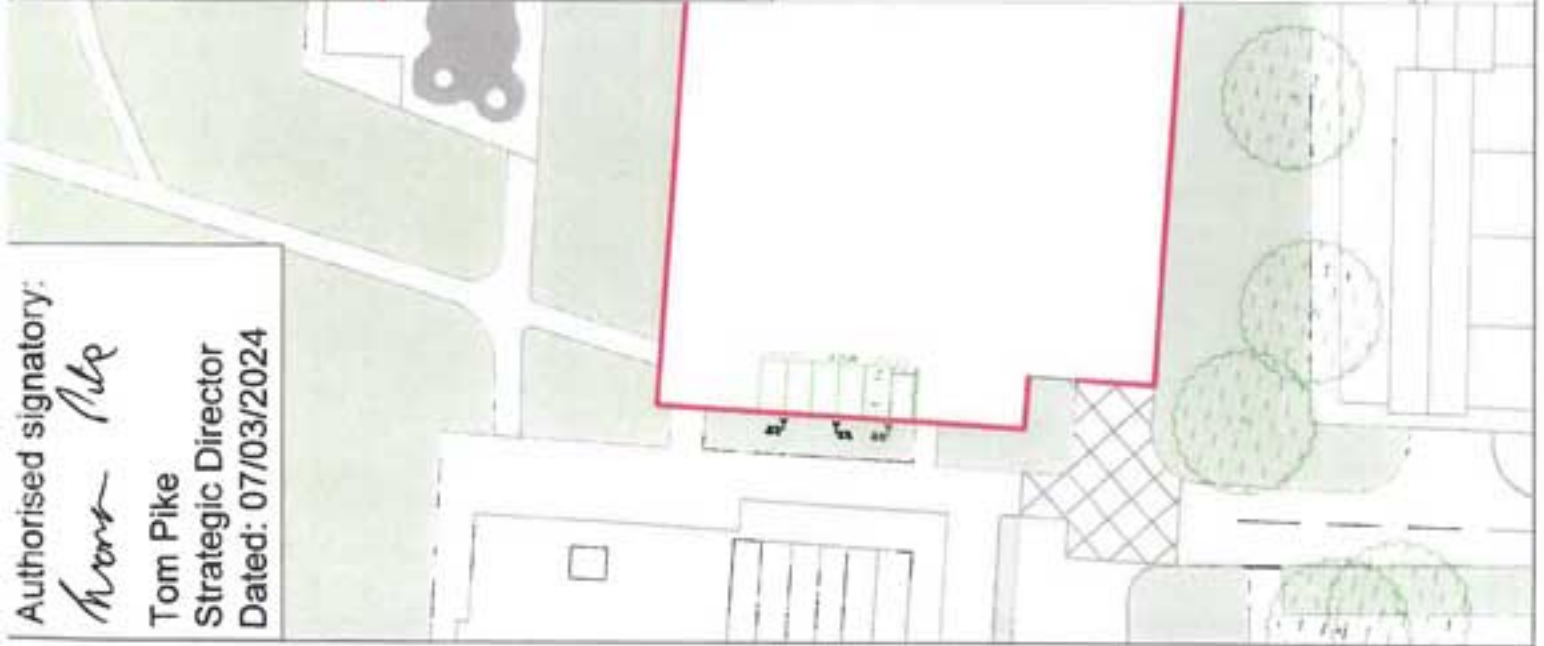

Electric Area  
 Electric Point Only  
 20kVA or greater

335

220

600

300

Sectional View A

Sectional View B



Project Name	
Client	
Location	
Date	
Scale	
Author	
Check	
Drawn	
Project No.	
Sheet No.	

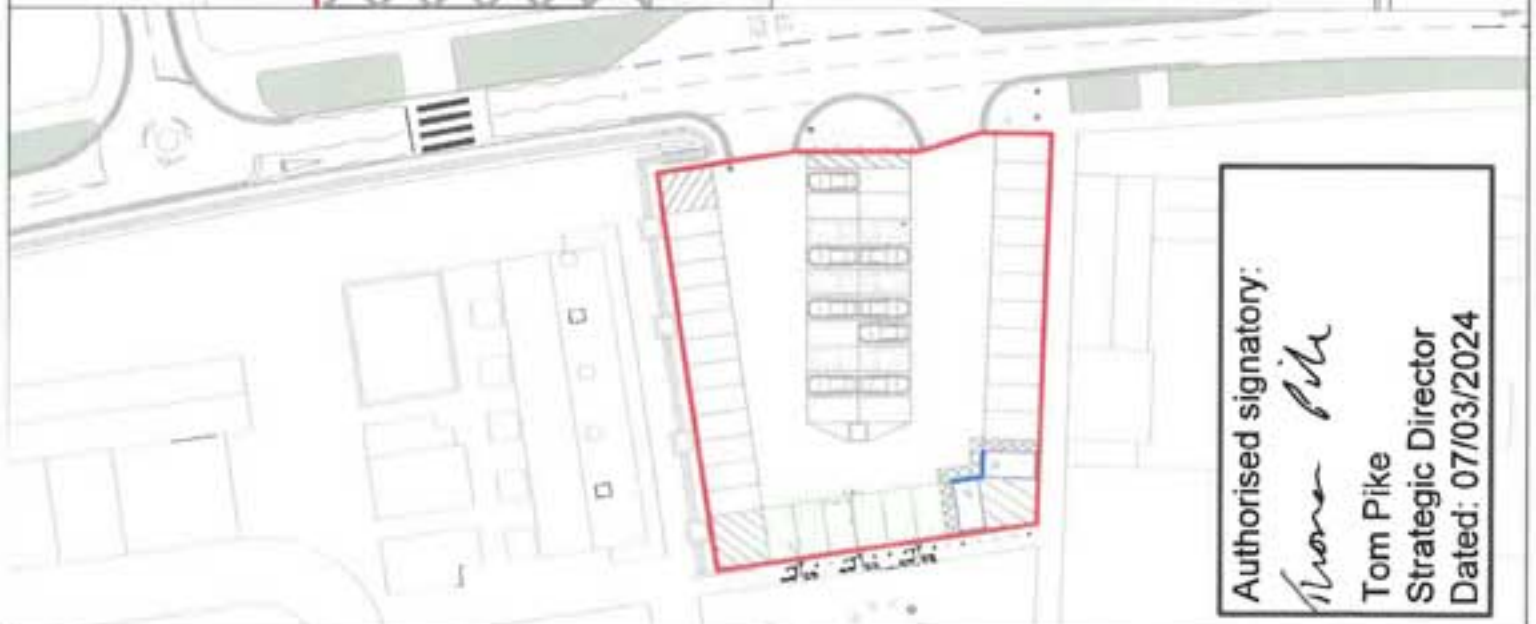

Authorised signatory:  
*Tom Pike*  
 Tom Pike  
 Strategic Director  
 Dated: 07/03/2024

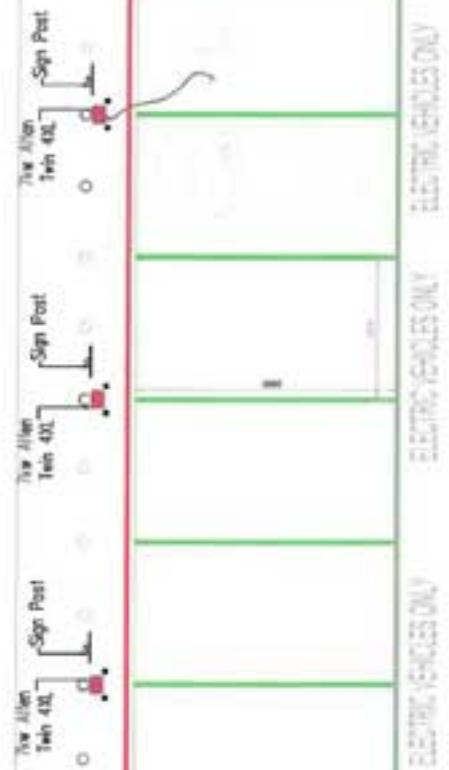

Sectional View A

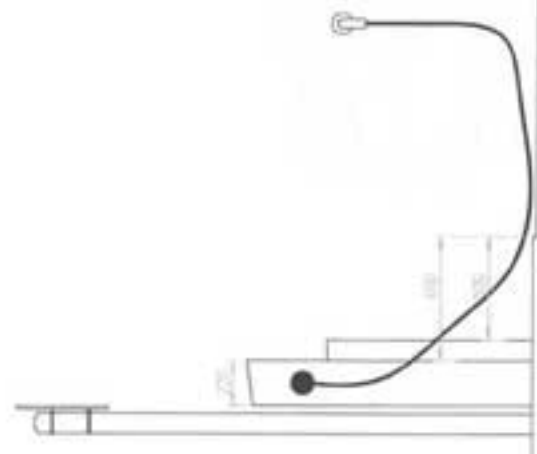

Sectional View B

62.  ELECTRIC VEHICLE CHARGING POINT ONLY  
 SIGNPOSTS AND SIGNPOSTS  
 NO HIGH BEAMS OR LANE

blink

Scale	1:100
Date	07/03/2024
Sheet	1 of 1
Project	EV Charging Station
Client	City of London
Location	City of London
Drawn by	[Name]
Checked by	[Name]
Approved by	[Name]

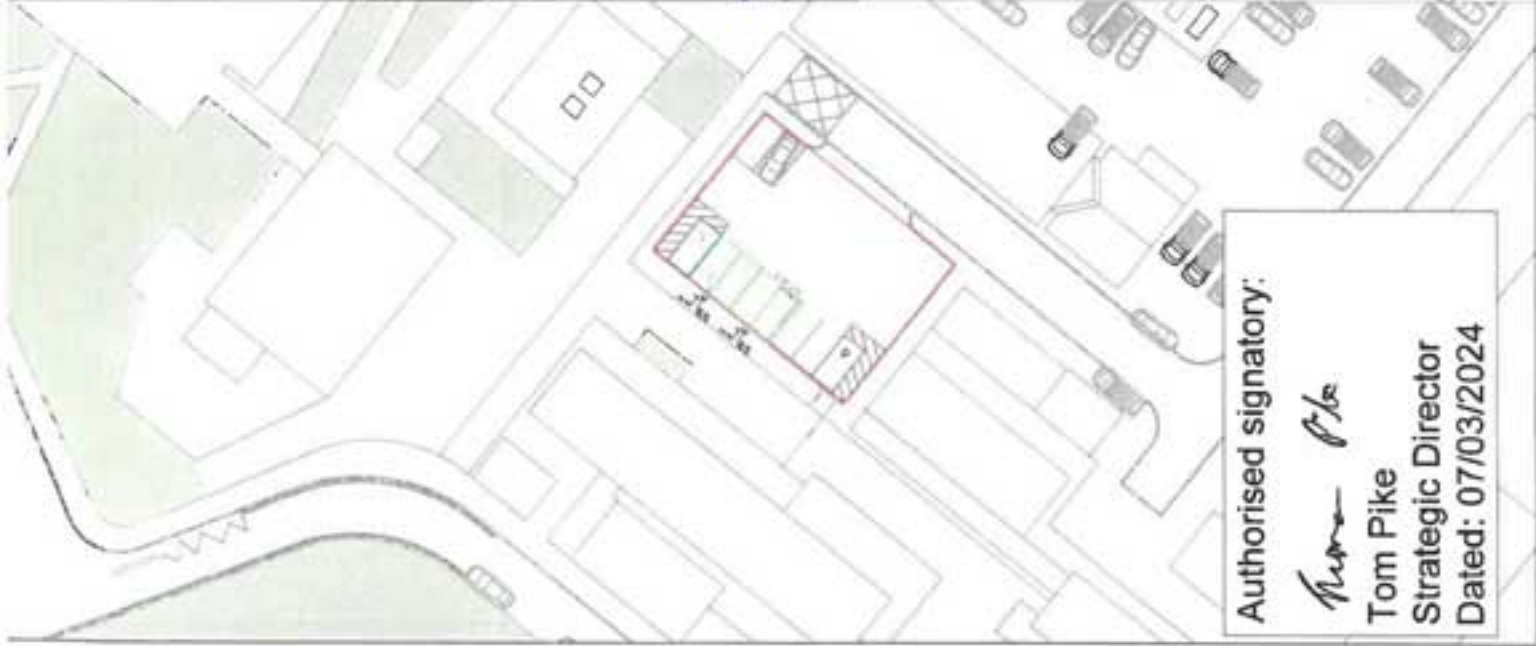

Authorised signatory:

*Tom Pike*

Tom Pike  
Strategic Director  
Dated: 07/03/2024

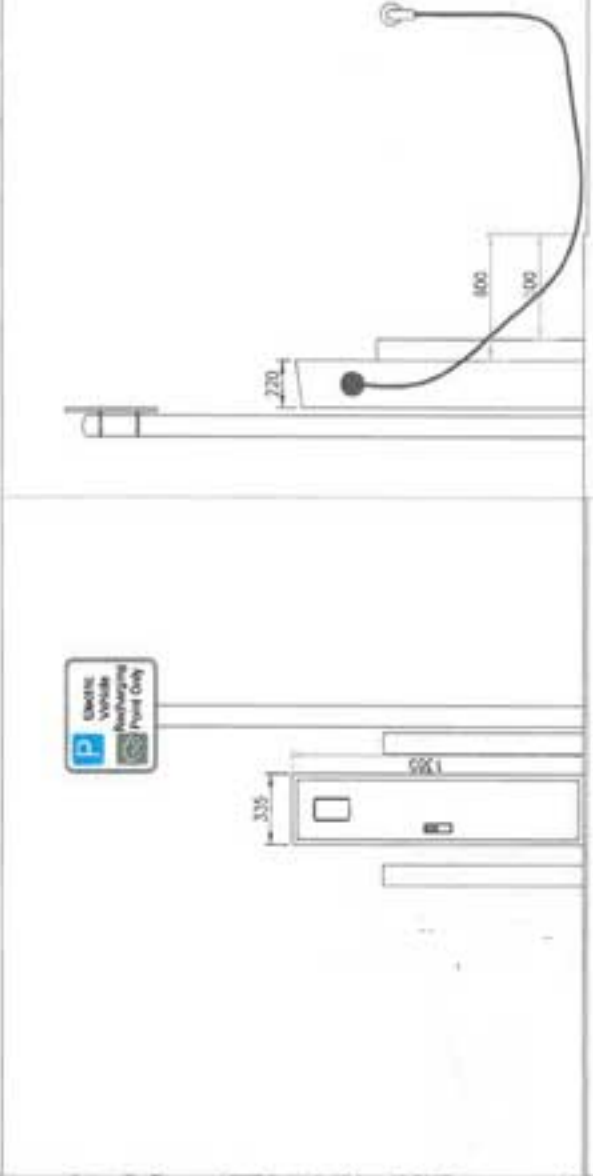
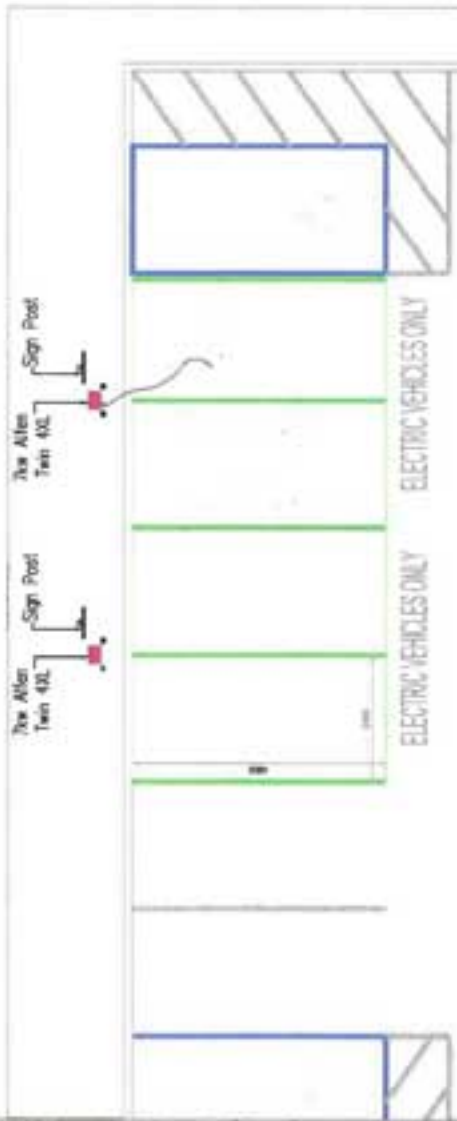

Sectional View A

Sectional View B

- 100mm WALL
- 200mm FOOTING
- 200mm CONCRETE
- 100mm FLOOR SLAB
- 100mm WALL ON GRADE



Project Name	
Client	
Address	
Site No.	
Scale	
Drawn By	
Checked By	
Date	



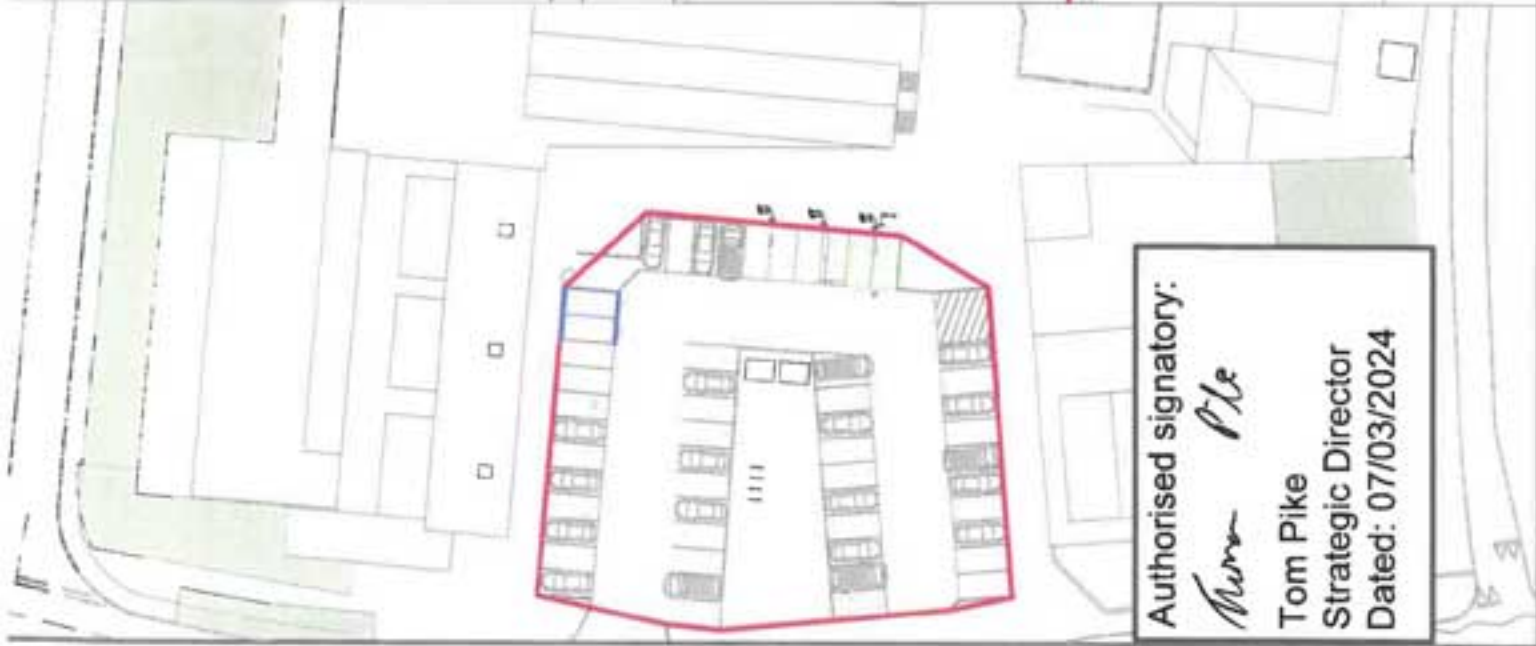

Authorised signatory:

*Tom Pike*

Tom Pike  
Strategic Director

Dated: 07/03/2024

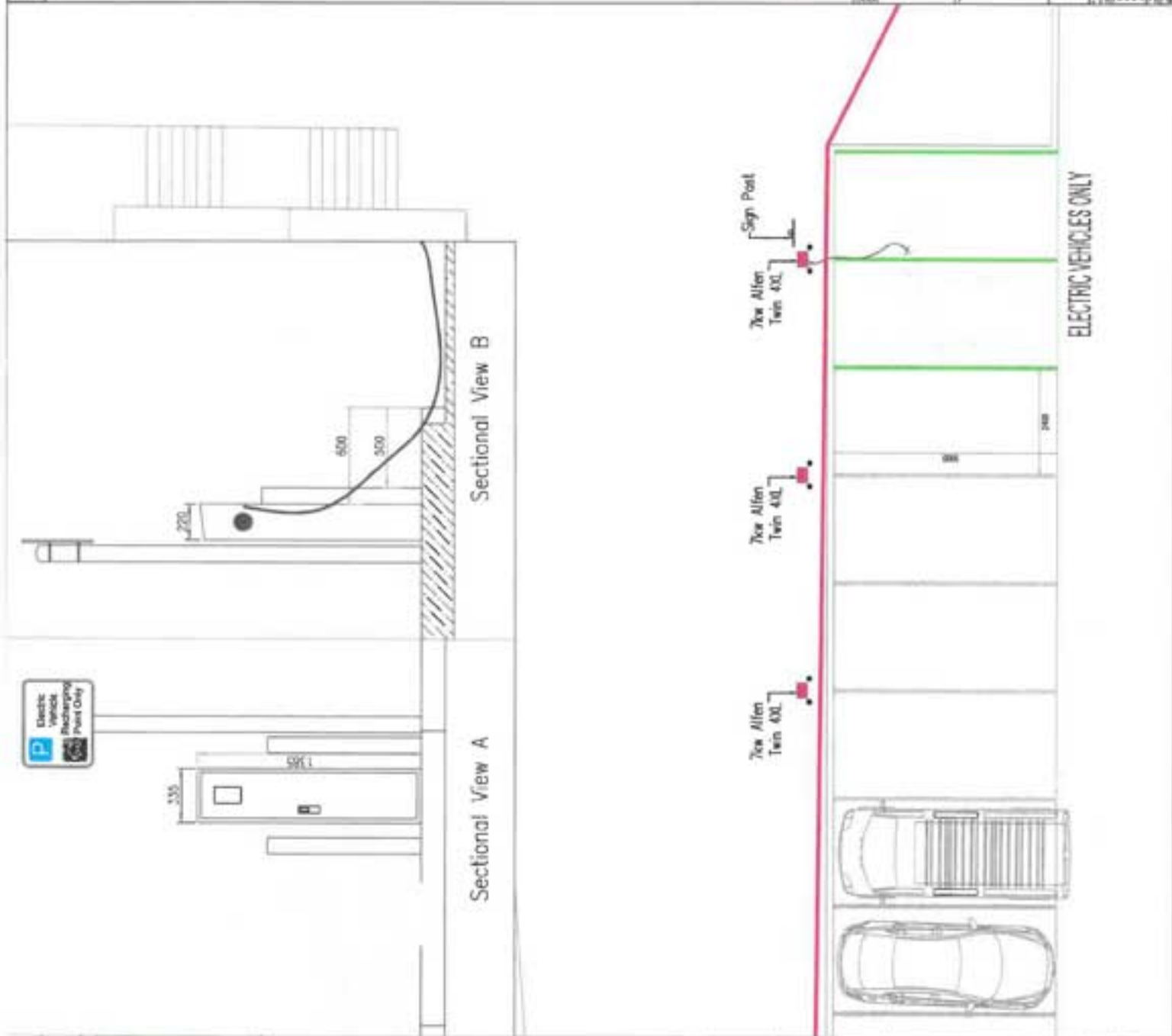

- ELECTRIC VEHICLE RECHARGING POINT ONLY
- SIGNAL POINTS / POWER PLANTS
- Other Data Items for A&E

*blinck*

blinck

Project Name: [ ]  
 Client: [ ]  
 Date: [ ]  
 Version: [ ]



Authorised signatory:  
*Tom Pike*  
 Tom Pike  
 Strategic Director  
 Dated: 07/03/2024

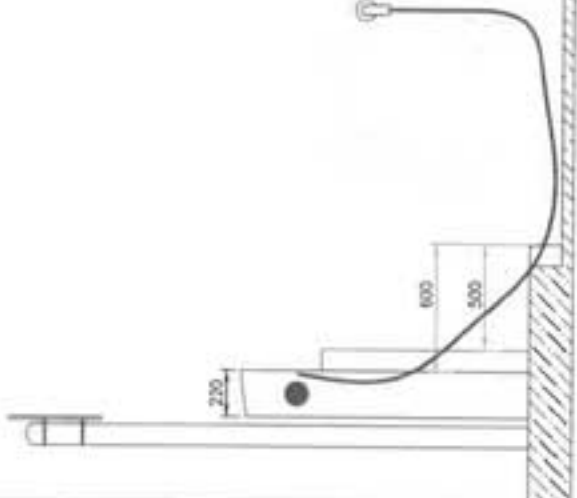
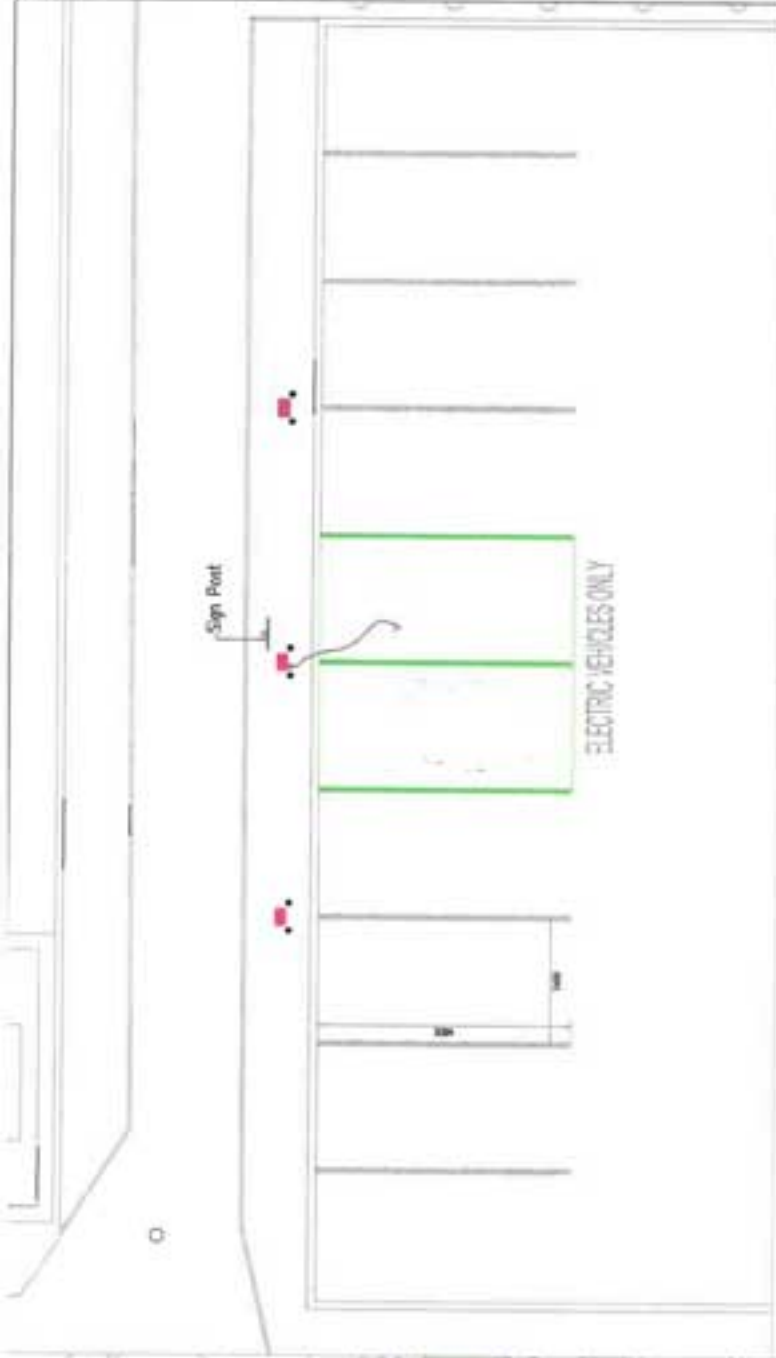

Sectional View A

Sectional View B

E.L.  
 1:100  
 07/03/2024  
 The One Stop Ltd

Logo for The One Stop Ltd featuring a stylized figure.  
 The One Stop Ltd  
 Strategic Director  
 Dated: 07/03/2024