

# Map showing proposed new road layout signs and markings

DO NOT SCALE OFF THIS DRAWING

**Notes:**

- Do not scale from this drawing. If in doubt refer to the project manager for clarification.
- All dimensions are shown in metres unless otherwise stated.
- Layout based on Ordnance Survey MasterMap, © Crown Copyright 2021. All rights reserved.
- This drawing forms part of a design pack and should be read in conjunction with all drawings listed on the project drawing register.
- All works shall be carried out in accordance with the approved drawings and specifications to the satisfaction of the Highway Authority.
- Base mapping and topographical survey supplied by Guinness Development Ltd.
- Prior to erection, all sign locations must be cleared of vegetation and foliage which may minimize visibility.
- All vegetation, trees and overhanging tree branches should be fully cleared within the nearside verge on the approach to each sign location to ensure a minimum clear visibility distance is provided to each sign.
- All clearance works to be carried out with bird nesting season unless an environmental review is carried out.
- Where signs are to be located on a pedestrian or cycle route the height to the underside of the sign shall be 2.4m.
- All signs and road markings to be in accordance with the Traffic Signs Regulations and General Directions 2016.
- Final position for all signs and road markings to be agreed on site.
- Signs and bollards to have minimum clearance of 500mm from edge of carriageway or 600mm from edge of Vehicle Restraint System.
- Prior to placing road markings, the contractor must ensure that proposed markings will tie in with existing road markings.
- All sign faces to be dg\*3 microprismatic material on aluminium backing.
- Minimum clear visibility of signs to be 75m.
- Temporary traffic management proposals to be submitted by the Contractor to Highway Authority and approved prior to commencement of works on site.

**KEY:**

- SDA Boundary
- Proposed Kerb
- Proposed Construction Hoarding
- - - Proposed Temporary Barrier (Water/Sand filled barrier up to 500mm in height)
- Proposed Road Markings. No waiting, no loading or unloading at anytime.
- S14 Proposed Sign - Restriction - Disabled badge holders only. Max stay 3 hours
- Proposed Rhino Stainless Steel Bollards

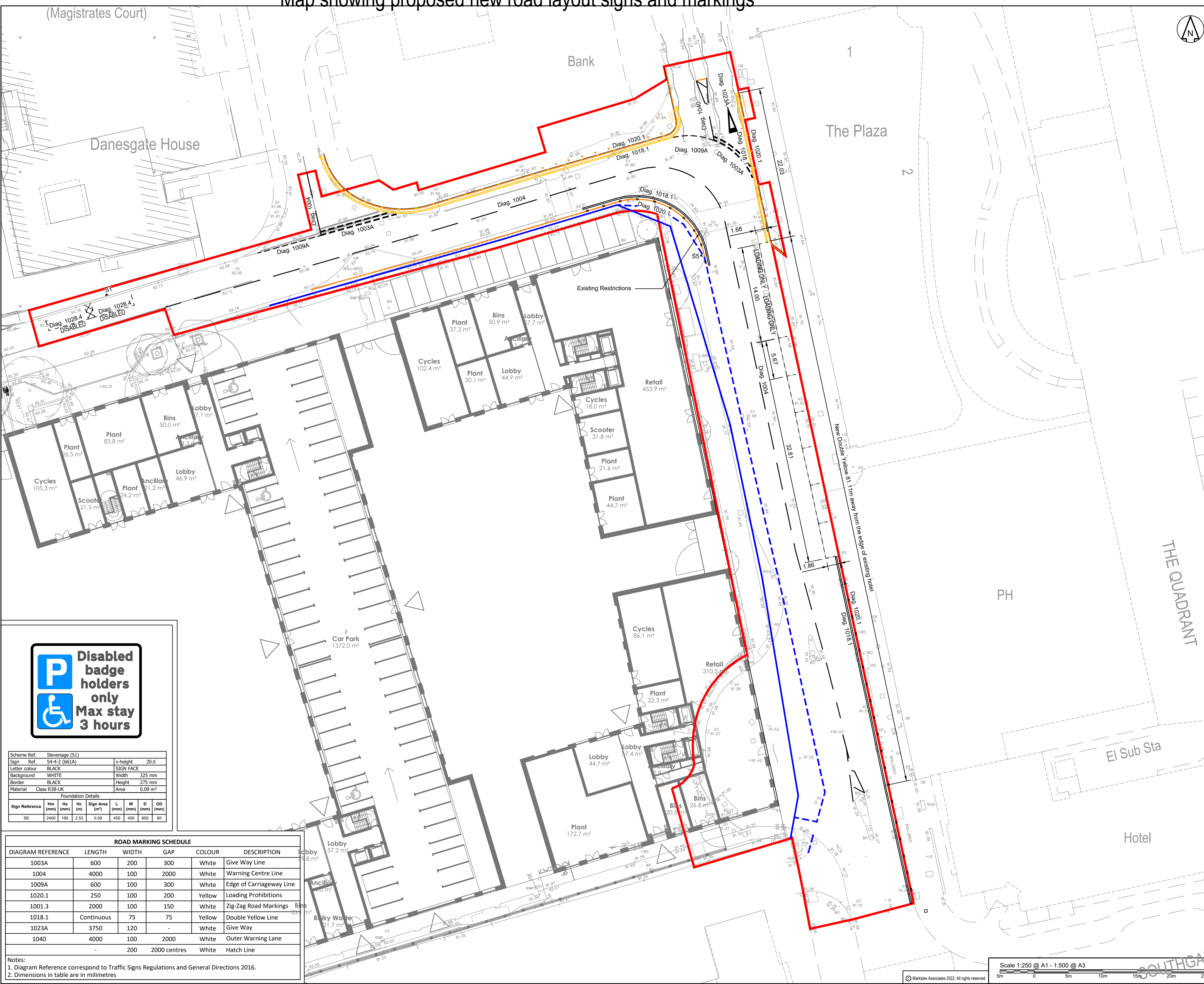

Scheme Ref.	Stevengage (S1)	x-height
Sign Ref.	S4-4-2 (661A)	20.0
Letter colour	BLACK	SIGN FACE
Background	WHITE	Width 325 mm
Border	BLACK	Height 275 mm
Material	Class R3B-UK	Area 0.09 m <sup>2</sup>

Sign Reference	Hm (mm)	Hs (mm)	Hc (m)	Sign Area (m <sup>2</sup> )	L (mm)	W (mm)	D (mm)	OD (mm)
S6	2400	195	2.53	0.09	450	450	600	60

DIAGRAM REFERENCE	LENGTH	WIDTH	GAP	COLOUR	DESCRIPTION
1003A	600	200	300	White	Give Way Line
1004	4000	100	2000	White	Warning Centre Line
1009A	600	100	300	White	Edge of Carriageway Line
1020.1	250	100	200	Yellow	Loading Prohibitions
1001.3	2000	100	150	White	Zig-Zag Road Markings
1018.1	Continuous	75	75	Yellow	Double Yellow Line
1023A	3750	120	-	White	Give Way
1040	4000	100	2000 centres	White	Outer Warning Lane
		200	2000 centres	White	Hatch Line

**Notes:**  
 1. Diagram Reference correspond to Traffic Signs Regulations and General Directions 2016.  
 2. Dimensions in table are in millimetres

Revision History						
Rev	Comment	By	Chkd	Appr	Date	
P04	FOR APPROVAL	LB	DM	DM	09.12.22	
P03	FOR APPROVAL	LB	DM	DM	06.12.22	
P02	FOR INFORMATION	LB	DM	DM	17.08.22	
P01	FOR INFORMATION	LB	DM	DM	12.08.22	
Rev	Comment	By	Chkd	Appr	Date	
Current Revision						
P04	FOR APPROVAL	LB	DM	DM	09.12.22	
Rev	Comment	By	Chkd	Appr	Date	

**S4 - FOR INFORMATION**

**GUINNESS DEVELOPMENT LTD**



Telephone: 0207 402 2225  
E: enquiries@markidesassociates.co.uk  
W: www.markidesassociates.co.uk

Project: **STEVENAGE TRO**  
 Drawing Title: **ROAD SIGNS AND MARKINGS**